

Legiolert 定量盘操作手册

附 MPN 表



美国爱德士

全球水中微生物检测领导者

400-678-6682 转 2

www.gbmicrotest.com

china-water@idexx.com

IDEXX

One IDEXX Drive
Westbrook, Maine 04092 USA

Legiolert 定量盘操作手册

介绍

Legiolert 与定量盘配合使用，使用 Quanti-tray 升级版程控定量封口机 Plus 封口后培养获得。阳性结果对照 MPN 表得到最终结果。

内容

96 孔定量盘，储存在 4-30°C，避光避免潮湿环境

操作说明

1. 用一只手握住 Legiolert 定量盘的孔格面
2. 紧握定量盘的顶部，并使孔格面弯曲向手心内
3. 打开定量盘纸板面，避免接触到定量盘内部

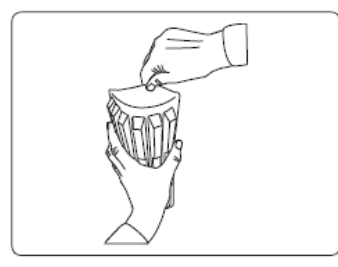
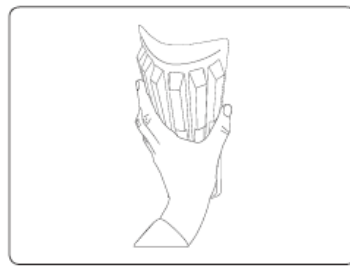
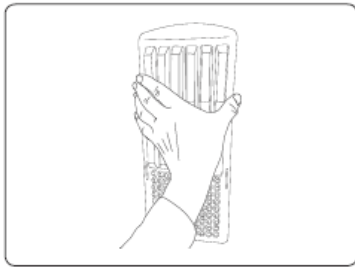

4. 将样品和试剂的混合液倒入 Legiolert 定量盘中，避免接触到定量盘内部
5. 将定量盘放入橡胶垫上，在 Quanti-tray 升级版程控定量封口机 Plus 中定量封口
6. 大孔不会充满液体
7. 根据 Legiolert 操作说明书培养定量盘
8. 数出阳性孔格数，对照 MPN 表获得最终结果

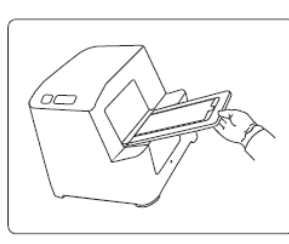
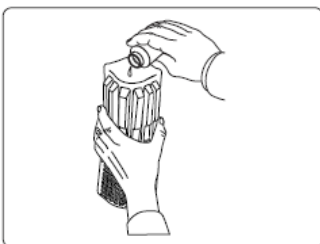

9. 阳性盘高压灭菌后通过专业机构处理

Legiolert 96 孔盘 MPN 表

		# 大孔阳性数						
		0	1	2	3	4	5	6
小孔阳性数	0	<1	1.1	2.3	3.9	5.8	8.4	12.6
	1	1.0	2.2	3.5	5.2	7.4	10.4	15.5
	2	2.0	3.2	4.7	6.6	9.0	12.4	18.7
	3	3.0	4.3	5.9	7.9	10.6	14.6	22.3
	4	4.0	5.4	7.2	9.4	12.3	16.9	26.4
	5	5.0	6.5	8.4	10.8	14.1	19.4	31.0
	6	6.0	7.7	9.7	12.3	15.9	21.9	36.1
	7	7.0	8.8	10.9	13.8	17.8	24.6	41.6
	8	8.1	9.9	12.2	15.3	19.8	27.5	47.4
	9	9.1	11.0	13.5	16.8	21.7	30.5	53.4
	10	10.1	12.2	14.8	18.4	23.8	33.5	59.6
	11	11.1	13.3	16.1	20.0	25.9	36.7	65.9
	12	12.1	14.5	17.5	21.6	28.0	40.0	72.3
	13	13.2	15.6	18.8	23.3	30.2	43.3	78.8
	14	14.2	16.8	20.2	24.9	32.4	46.7	85.4
	15	15.2	18.0	21.5	26.6	34.7	50.1	92.1
	16	16.3	19.1	22.9	28.3	37.0	53.6	98.9
	17	17.3	20.3	24.3	30.1	39.3	57.1	105.7
	18	18.3	21.5	25.7	31.8	41.6	60.6	112.7
	19	19.4	22.7	27.1	33.6	44.0	64.2	119.8
	20	20.4	23.9	28.5	35.3	46.4	67.8	126.9
	21	21.4	25.1	30.0	37.1	48.8	71.5	134.2
	22	22.5	26.3	31.4	38.9	51.2	75.1	141.6
	23	23.5	27.5	32.9	40.7	53.7	78.8	149.0
	24	24.6	28.7	34.3	42.6	56.1	82.5	156.6
	25	25.6	29.9	35.8	44.4	58.6	86.3	164.4
	26	26.7	31.1	37.2	46.2	61.1	90.1	172.2
	27	27.7	32.4	38.7	48.1	63.6	93.9	180.1
	28	28.8	33.6	40.2	49.9	66.1	97.7	188.2
	29	29.9	34.8	41.7	51.8	68.6	101.6	196.4
	30	30.9	36.1	43.1	53.7	71.1	105.5	204.8
	31	32.0	37.3	44.6	55.6	73.7	109.4	213.3
	32	33.1	38.5	46.1	57.5	76.2	113.3	221.9
	33	34.1	39.8	47.6	59.4	78.8	117.3	230.7
	34	35.2	41.0	49.2	61.3	81.4	121.3	239.6
	35	36.3	42.3	50.7	63.2	84.0	125.4	248.7
	36	37.3	43.5	52.2	65.1	86.6	129.5	258.0
	37	38.4	44.8	53.7	67.1	89.3	133.6	267.4
	38	39.5	46.1	55.3	69.0	91.9	137.7	277.1
	39	40.6	47.3	56.8	71.0	94.6	141.9	286.9

小 孔 阳 性 数	40	41.7	48.6	58.3	72.9	97.2	146.1	296.9
	41	42.8	49.9	59.9	74.9	99.9	150.4	307.1
	42	43.8	51.2	61.4	76.8	102.6	154.7	317.5
	43	44.9	52.5	63.0	78.8	105.4	159.0	328.1
	44	46.0	53.7	64.5	80.8	108.1	163.4	339.0
	45	47.1	55.0	66.1	82.8	110.8	167.8	350.1
	46	48.2	56.3	67.7	84.8	113.6	172.2	361.4
	47	49.3	57.6	69.3	86.8	116.4	176.7	373.0
	48	50.4	58.9	70.8	88.8	119.2	181.2	384.9
	49	51.5	60.2	72.4	90.9	122.0	185.8	397.1
	50	52.6	61.5	74.0	92.9	124.8	190.4	409.6
	51	53.8	62.8	75.6	94.9	127.6	195.1	422.3
	52	54.9	64.1	77.2	97.0	130.5	199.7	435.5
	53	56.0	65.5	78.8	99.1	133.4	204.5	448.9
	54	57.1	66.8	80.4	101.1	136.2	209.3	462.8
	55	58.2	68.1	82.1	103.2	139.2	214.1	477.0
	56	59.3	69.4	83.7	105.3	142.1	218.9	491.6
	57	60.5	70.8	85.3	107.4	145.0	223.9	506.7
	58	61.6	72.1	86.9	109.5	148.0	228.8	522.3
	59	62.7	73.4	88.6	111.6	150.9	233.8	538.3
	60	63.9	74.8	90.2	113.7	153.9	238.9	554.9
	61	65.0	76.1	91.9	115.9	156.9	244.0	572.0
	62	66.1	77.5	93.5	118.0	160.0	249.2	589.7
	63	67.3	78.8	95.2	120.1	163.0	254.4	608.1
	64	68.4	80.2	96.8	122.3	166.1	259.7	627.1
	65	69.6	81.5	98.5	124.5	169.2	265.0	646.9
	66	70.7	82.9	100.2	126.6	172.3	270.4	667.6
	67	71.9	84.3	101.9	128.8	175.4	275.9	689.0
	68	73.0	85.6	103.6	131.0	178.5	281.4	711.5
	69	74.2	87.0	105.3	133.2	181.7	287.0	735.0
	70	75.3	88.4	107.0	135.4	184.9	292.6	759.6
	71	76.5	89.8	108.7	137.7	188.1	298.3	785.5
	72	77.7	91.2	110.4	139.9	191.3	304.0	812.8
73	78.8	92.6	112.1	142.1	194.5	309.9	841.7	
74	80.0	93.9	113.8	144.4	197.8	315.8	872.3	
75	81.2	95.3	115.5	146.7	201.1	321.7	904.9	
76	82.3	96.7	117.3	148.9	204.4	327.8	939.8	
77	83.5	98.2	119.0	151.2	207.7	333.9	977.2	
78	84.7	99.6	120.8	153.5	211.0	340.0	1017.6	
79	85.9	101.0	122.5	155.8	214.4	346.3	1061.6	
80	87.1	102.4	124.3	158.1	217.8	352.6	1109.7	
81	88.3	103.8	126.0	160.5	221.2	359.1	1162.9	
82	89.5	105.2	127.8	162.8	224.6	365.6	1222.4	
83	90.7	106.7	129.6	165.2	228.1	372.1	1289.8	

小 孔 阳 性 数	84	91.9	108.1	131.4	167.5	231.6	378.8	1367.7
	85	93.1	109.5	133.2	169.9	235.1	385.6	1459.8
	86	94.3	111.0	135.0	172.3	238.6	392.4	1572.5
	87	95.5	112.4	136.8	174.7	242.2	399.4	1717.8
	88	96.7	113.9	138.6	177.1	245.8	406.4	1922.6
	89	97.9	115.3	140.4	179.5	249.4	413.6	2272.6
	90	99.1	116.8	142.2	181.9	253.0	420.8	>2272.6